

# BT433S

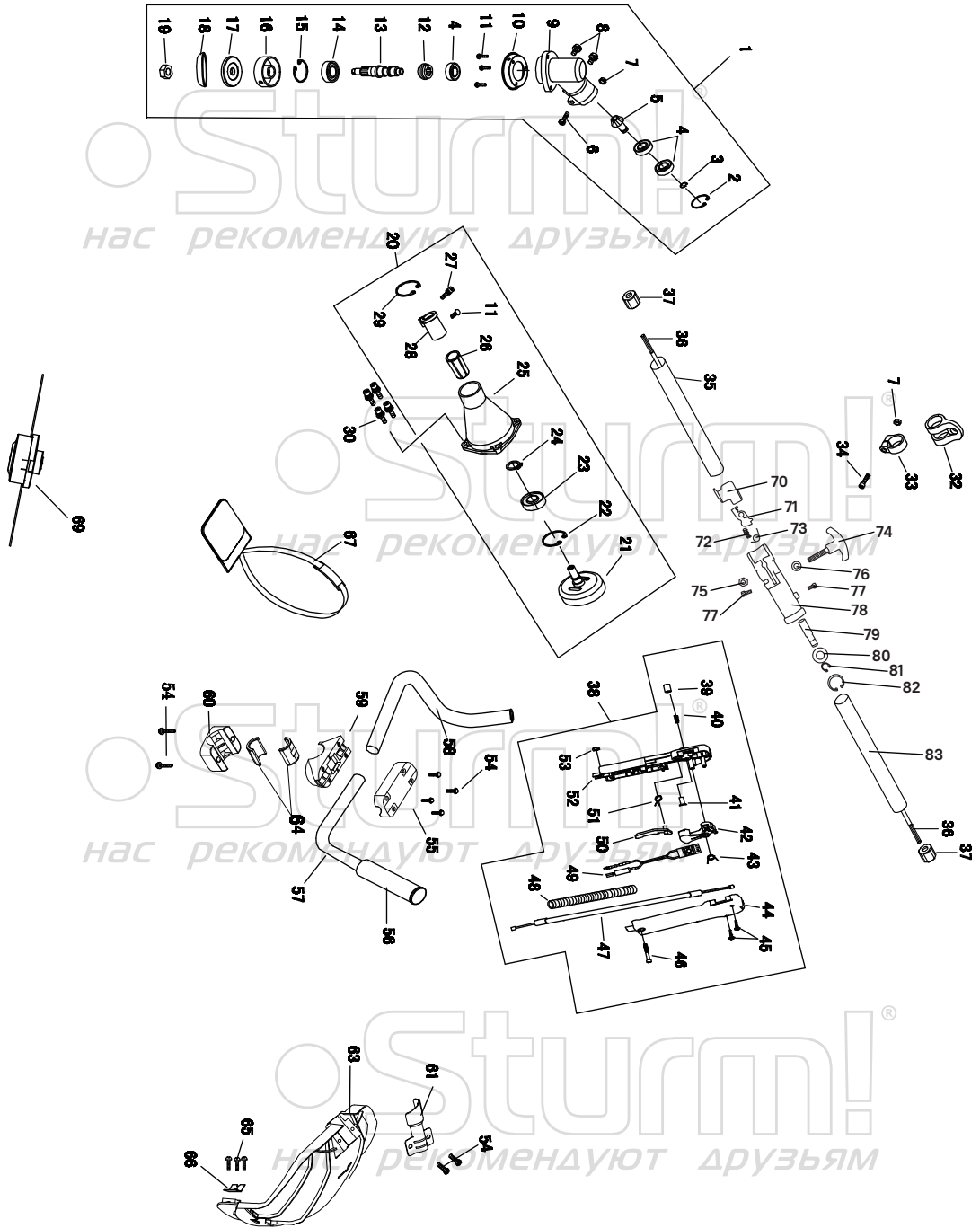

NO.	DESCRIPTION	NO.	DESCRIPTION
1	GEAR BOX	41	LOCKPIN
2	RING 26	42	THROTTLE LEVER
3	RING 10	43	SPRING
4	BEARING 6000-2RS	44	BOX,RIGHT
5	PINION	45	SCREW ST4X16
6	SCREW M5X35	46	SCREW M6X30
7	NUT M5	47	CABLE COMP
8	SCREW ASSY M6X12	48	TUBE
9	GEAR BOX	49	STOP SWITCH
10	SAFETY COVER A	50	SAFETY LEVER
11	SCREW ASSY M5X12	51	SPRING
12	GEAR	52	BOX,LEFT
13	GEAR SHAFT	53	NUT M6
14	BEARING 6002-2RS	54	SCREW ASSY M5X25
15	RING 32	55	CAP,UPPER
16	HOLDER A	56	RUBBER COVER
17	HOLDER B	57	LEFT HANDGRIP
18	SAFETY COVER B	58	RIGHT HANDGRIP
19	LEFT NUT M10	59	BRACKET
20	CLUTCH COMP	60	CAP,LOWER
21	CLUTCH DRUM COMP	61	BRACKET
22	RING 35	63	SAFETY GUARD
23	BEARING 6202-2RS	64	BUSH
24	RING 15	65	SCREW ST4X10
25	CLUTCH CASE	66	GUARD BLADE
26	RUBBER COVER	67	HARNESS ASS'Y
27	SCREW ASSY M6X25	69	NYLON CUTTER HEAD
28	CONNECTING ROD	70	COVER PLATE
29	RING 45	71	CLIP
30	SCREW ASSY M6X30	72	COMPRESSION SPRING
31	RUBBER COVER	73	TORSION SPRING
32	HARNESS CLAMP	74	KNOB
33	CLAMP	75	NUT M8
34	SCREW M5X20	76	FLAT WASHER
35	UPPER PIPE	77	SCREW M5X14
36	DRIVE SHAFT	78	QUICK-CONNECT ALUMINUM PART
37	OIL-BEARING	79	9-TOOTH OUTPUT SHAFT
38	LEVEL ASS'Y	80	SEALED BEARING 6000
39	BUTTON	81	Ø10 SHAFT CIRCLIP
40	SPRING	82	Ø26 INTERNAL CIRCLIP
		83	LOWER PIPE

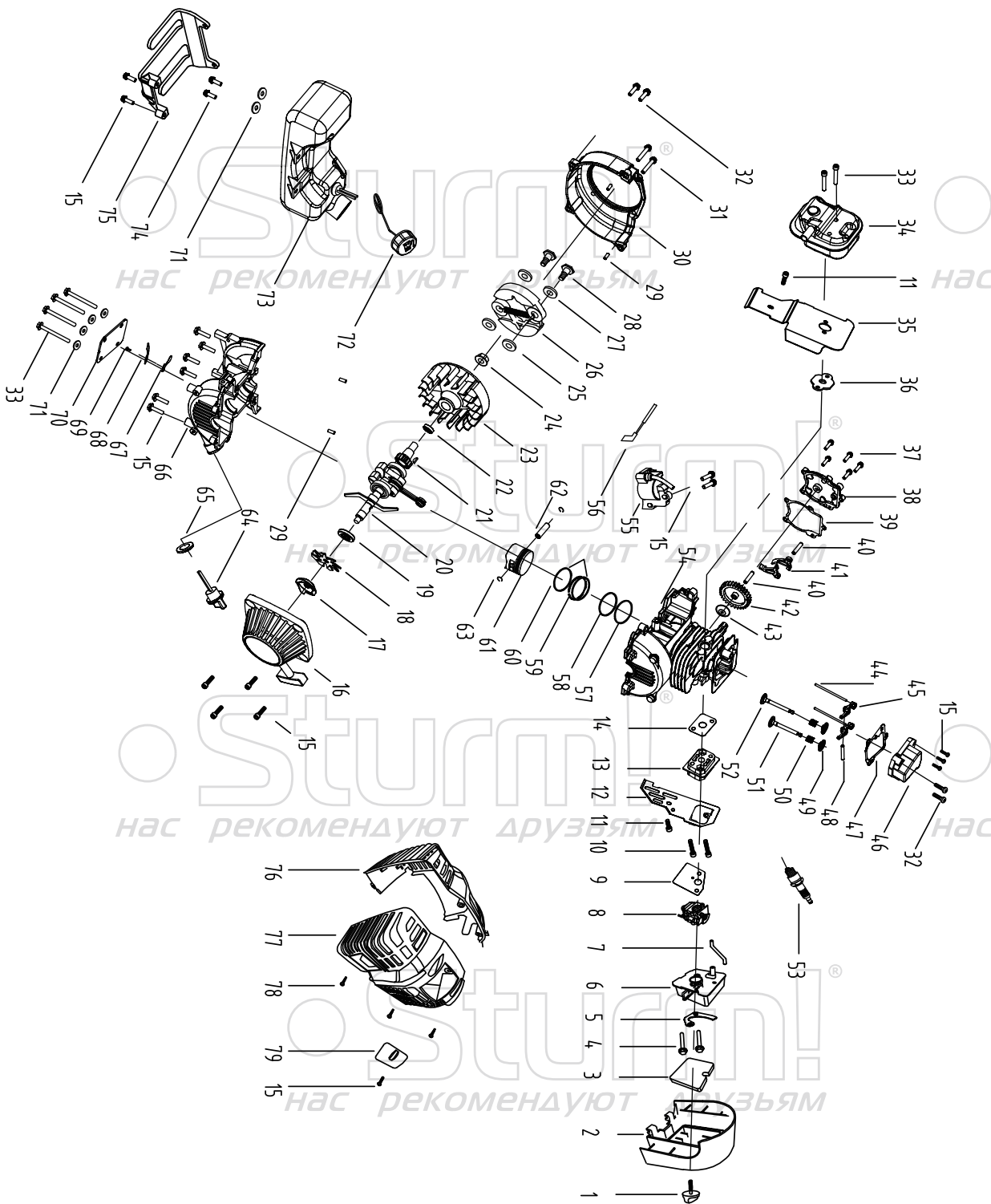

## GASOLINE ENGINE BT433S

NO.	DESCRIPTION	NO.	DESCRIPTION
1	LOCKING NUT M4×17	41	BELOW ROCKER
2	AIR FILTER COVER	42	CAM WHEEL
3	AIR FILTER SPONGE	43	CAM WHEEL WASHER
4	SCREW M4×17	44	JIB
5	ANTI-OIL BOARD	45	UPPER ROCKER
6	AIR FILTER SET	46	CYLINDER COVER
7	WIND PIPE	47	CYLINDER COVER WASHER
8	CARBURETOR	48	PIN Ø4*30.5
9	CARBURETOR PAPER WASHER	49	SPRING SEAT
10	BOLT M5X35	50	SPRING
11	BOLT M5X12	51	OUTPUT VALVE
12	ADMITTING PIPE BOARD	52	INPUT VALVE
13	ADMITTING PIPE	53	SPARK PLUG
14	ADMITTING PIPE R WASHER	54	CYLINDER
15	BOLT M5X20	55	IGNITOR
16	STATER	56	FLAMEOUT CABLE
17	START PAWL	57	FIRST PISTON RING
18	FAN	58	SECOND PISTON RING
19	OIL SEAL Ø25*Ø12*6	59	WAVE RING
20	CRANK	60	RING
21	KEY 3*5*13	61	PISTON
22	OIL SEAL Ø25*Ø15*6	62	PISTON PIN
23	FLY WHEEL	63	PISTON PIN CIRCLIP
24	NUT M10X1.25	64	DIPSTICK
25	CLUTCH WASHER Ø16*Ø8*1.5	65	DIPSTICK O-RING
26	CLUTCH	66	CASE
27	WAVE WASHER Ø16*Ø11*0.4	67	REED
28	BOLT M8*10*25	68	BOARD
29	PIN Ø4*8	69	SCREW M3X8
30	SIDE COVER	70	BOARD
31	BOLT M5X30	71	WASH Ø5
32	BOLT M5X25	72	FUEL TANK COVER
33	BOLT M5X55	73	FUEL TANK
34	MUFFLER	74	BOLT M5X16
35	MUFFLER BOARD	75	FUEL TANK BRACKET
36	MUFFLER WASHER	76	CASE FRONT COVER
37	SCREW M4X16	77	CASE REAR COVER
38	SIDE COVER	78	SCREW ST5X14
39	SIDE COVER WASHER	79	SPARK PLUG COVER
40	SIDE PIN Ø5*25.6		

BT433S-EX-RU250923-1